

## FITTING GUIDE AND TEMPLATE

### Tool list:

- Drill
- 13mm ( $\frac{1}{2}$ ") & 32mm ( $1\frac{1}{4}$ ") drill bits
- 19mm ( $\frac{3}{4}$ ") chisel
- Bradawl
- Mallet
- Pozidrive screwdriver
- Small round and flat files
- Pencil
- Ruler
- Scissors

NB Equivalent imperial sizes are approximate  
All fixing screws supplied S440 175B

# Chubb

## 4L67 : BS 3621 INSURANCE CYLINDER RIM LOCK

Before commencing please read thoroughly to familiarise yourself with these instructions and use of the template. Illustrations show both internal and external views, based on a door hung right, opening inward viewed from the inside. The lock however is suitable for inward opening doors hinged left or right.

### IMPORTANT NOTE:

Deadlocking with the key locks the knob to give extra security. Care should be taken not to lock anyone inside the premises, particularly if your home has only one exit. The bolt automatically deadlocks each time the door is closed.

### Fining Replacement Lock

Position the template with the cylinder hole 'B' positioned centrally over the existing cylinder hole in the door. Check that the backset (distance from edge of door to centre of keyhole is the same as existing). Proceed as figure 1a. and 1b, marking the appropriate height line relevant to the existing cylinder hole. Then proceed from figure 3a.

### First Fit

1a. Mark the height line on the frame, internal door face and door edge 35mm ( $1\frac{3}{8}$ ") above the desired external keyhole position. Select the appropriate template for your door when viewed from the inside:-  
Template 1- inward opening door hinged on the right.  
Template 2- inward opening door hinged on the left.  
Carefully cut template from the fitting guide along the bold dotted line.

1b. Fold the template along the door edge line indicated and place on internal door face with the top edge of the template level with the height line. The template can now be taped temporarily in position to prevent movement. Mark the centre of all holes.

2a. Drill two 13mm ( $\frac{1}{2}$ ") diameter holes on centres 'A'. Drill through the door until the drill breaks through on opposite side. Working from the opposite side complete drilling.

Please ensure the drill is level and straight and take care when the drill breaks through on the opposite side to reduce splintering.

2b. Drill a 32mm ( $1\frac{1}{4}$ ") diameter hole on centre 'B'. Hole 'B' should break into holes 'A' equally. Follow instructions given in '2a' as regards drilling.

3a. Use a 13mm ( $\frac{1}{2}$ ") diameter file and a small flat file to prepare the cylinder lug holes to ensure a snug fit. Prepare wood screw fixing holes 'C' and 'D' with a bradawl.

3b. Withdraw lock bolt by turning knob clockwise and retain by pressing lock case button. Remove the two mounting plate retaining screws, then slide mounting plate back to release it from lock, keep retaining screws for reassembly.

**DO NOT OPERATE LOCK WHEN MOUNTING PLATE HAS BEEN REMOVED**

4a. Position lock body up to height line and mark around forend lip.

4b. Chisel out recess to ensure lip lies flush with door edge.

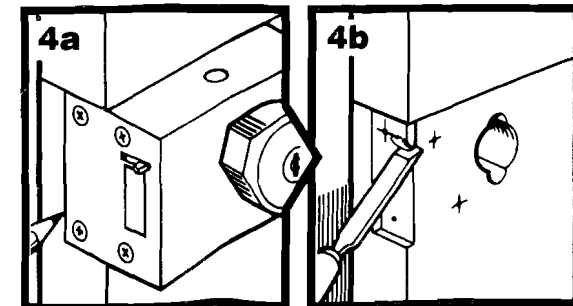
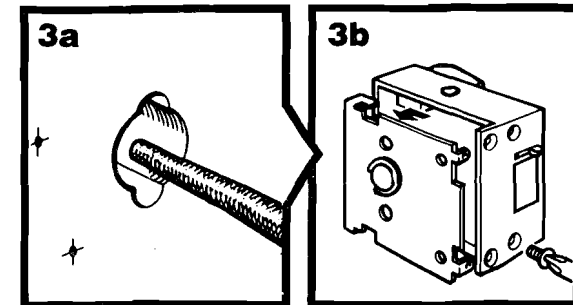
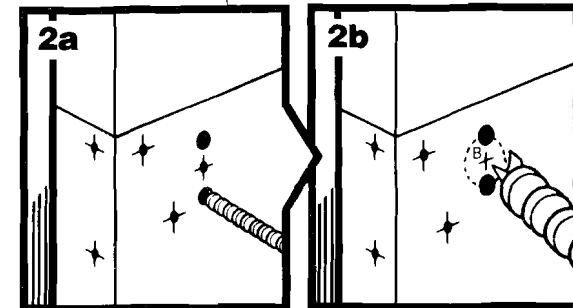
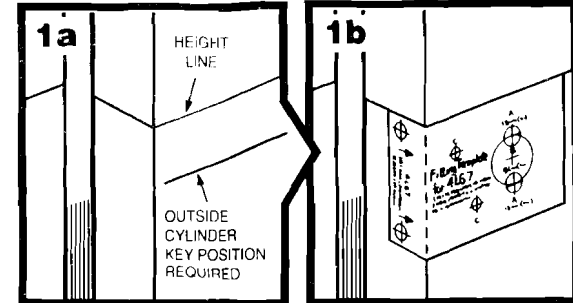

5a From outside locate cylinder and protection sleeve with or without door pull 4L P (available separately) into door. Ensure the end of protection sleeve is flush with the inside face of door.

5b. Shorten the cylinder connecting bar so that it projects beyond the inside face of the door by 10mm (3/8") and if required shorten the cylinder connecting screws to suit door thickness.

6a. From outside replace cylinder, protection sleeve and door pull (if applicable). From inside locate the mounting plate on the door level with the forend recess on the door edge. Ensure the cylinder connecting bar engages into the cam (it may be helpful to use a thin screwdriver to guide the connecting bar into the slot in the mounting plate) and the cam is correctly positioned (see illustration).

6b. Secure the cylinder with connecting screws and tighten until cylinder is drawn firmly against door face. DO NOT OVERTIGHTEN. Offer the lock case up to the mounting plate (see 7a) to ensure correct alignment of the plate before proceeding. If misaligned, loosen connecting screws, reposition plate and tighten screws. DO NOT OVERTIGHTEN. When satisfied mounting plate is square on door and level with forend recess, secure with two No 6 x 25mm (1") wood screws on centres C.

**Fitting The Lockcase**

7a. Wedge the door open. (A) Offer the lock to mounting plate and locate 'L' shaped pegs on mounting plate into back of lock and (B) slide firmly into position.

7b. Ensure forend lip is flush with door edge and that the two fixing holes line up with the previously prepared centres (D). Replace the mounting plate retaining screws and secure to door edge with two No 8 x 32mm (1 1/4") wood screws. With the door in the open position, check the bolt operation with the key from outside and with the knob from the inside (see operating instructions).

**Flush Doors And Frames**

8a. If the frame and door face are flush, position the staple level with the height line on the door frame and mark the outline of staple lip. If necessary, recess frame to take staple lip to give a gap of between 2.5 to 3.5mm (1/8") between lock and staple when door is closed. If 3.5mm (1/8") is exceeded, the slam action deadlocking bolt will not function. Mark position of the three staple fixing holes and secure with three No 10 x 50mm (2") wood screws (it may be necessary to drill pilot holes). Test operation of lock before closing door.

**Non-Flush Doors And Frames**

8b. If the frame and door face are not flush, the frame will have to be recessed to ensure the staple is seated exactly opposite the lock and level with the height line, giving correct engagement of bolt into staple. When staple is seated correctly, proceed as 8a, taking into account that if staple lip has to be recessed, extra wood may have to be removed from rear of staple.

Close the door and operate the bolt with knob to ensure smooth function. Open the door and test deadlock facility with key (see operating instructions).

When the door is shut and bolt enters staple, it is quite normal for minimum play to be apparent between the staple and bolt. This is not a defect but necessary to prevent the bolt from binding, causing premature wear.

When fitting, use all parts supplied with the lock to comply with BS 3621:1980.

If the lock requires lubricating, use only a proprietary maintenance fluid (e.g. WD40) not oil.

Use only a soft moist cloth to clean lock body and staple.

DO NOT USE AN ABRASIVE CLEANER, SOLVENTS OR POLISH.

**Additional Keys**

To ensure trouble-free operation of lock, please request that extra keys are cut from genuine Chubb key blanks.

**Operating Instructions**

- Unlock from outside by turning cylinder key clockwise.
- Turn knob clockwise to open door from inside.
- Lock knob by turning key clockwise and depressing the entire knob. Keeping the knob depressed, turn key anti-clockwise and remove. Repeat key operation to unlock (the knob will spring out).
- The bolt automatically deadlocks each time the door is closed.
- To retain bolt in the withdrawn position, turn knob clockwise and depress lockcase button.
- When leaving the premises, lock the knob and close the door.

**IMPORTANT:**

Ensure that those left inside have access to a key for means of leaving the premises once knob is locked.

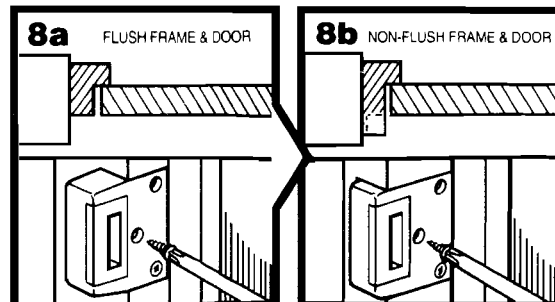
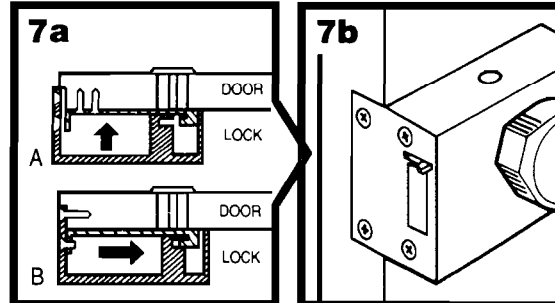
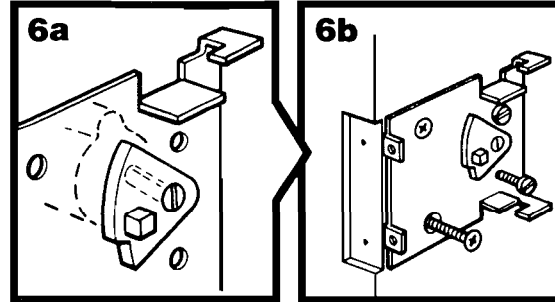
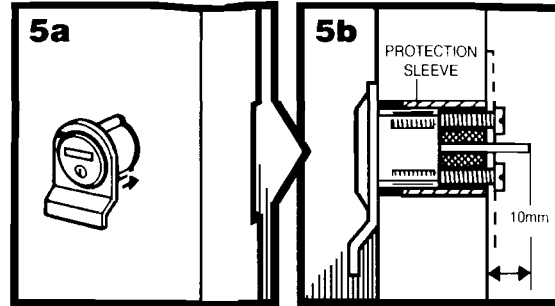

NB All dimensions quoted in the fitting guide and on the template are approximate and for guidance only. The lock may differ slightly from the illustrations shown E & OE.

**Chubb Locks**  
Wood Street,  
Willenhall, WV13 1LA  
Telephone: 01902 366911

Printed in England

CAREFULLY CUT ALONG LINE AND PLACE EDGE ON HEIGHT LINE

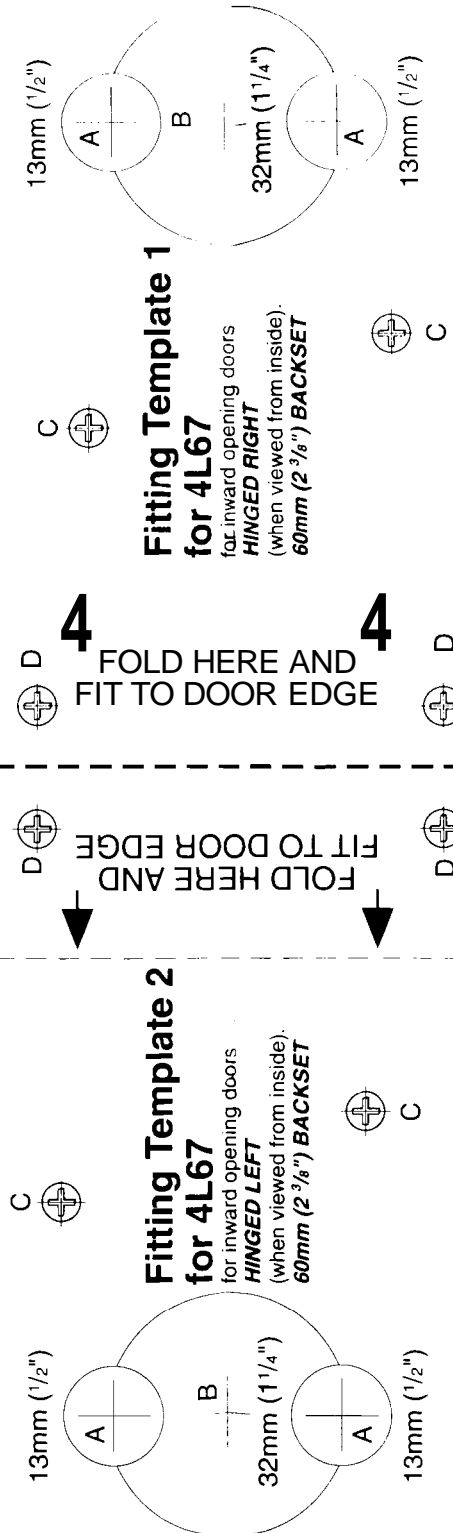

Due to working tolerances in both printing and manufacture, minimal variation may exist between template and product. Please check before proceeding.

⊕ INDICATES FIXING SCREW CENTRE